

## LODGE - FACT SHEET

Kopano Lodge & The Reserve Pg1 | Architectural Layouts Pg2 | Reference Table Pg3

Kopano Lodge | Tel: +27 (0)18 350 9902 | Email: [res@madikwesafarilodge.co.za](mailto:res@madikwesafarilodge.co.za)

### About the Lodge

Madikwe Safari Lodge's Kopano Lodge is ideally located for guests to appreciate the vastness and diversity of Madikwe Game Reserve's landscapes and wildlife. The modern lodge, influenced by an African design aesthetic, comprises just 4 luxury Suites and reminds of a traditional homestead. Kopano (meaning 'small gathering' in Setswana) can be booked out on an exclusive basis and is well-suited to a get-together of friends or family. Each Suite's private lounge, viewing deck, and plunge pool provide personal space and are ideal positions from where to spot the animals coming by.

### Lodge Features

- **Main lodge viewing/dining deck**
- **Boma terrace, hosting fireside diners under the stars**
- **Indoor dining room, with a fireplace**
- **Guest lounge, with a fireplace and library nook**
- **Kosher dining offering to ensure our Jewish guests can enjoy every treat a stay here has to offer**
- **Access to Lelapa Lodge's guest pool, positioned just up a waterhole for an incredible 'poolside safari'**
- **In-room spa and beauty treatments at the hands of expert therapists**
- **Complimentary Wi-Fi – but we recommend reconnecting with each other**
- **Madikwe Safari Lodge Gallery (at Lelapa Lodge), retailing rare and beautiful keepsakes, as well as everyday essentials**

### Location

Kopano Lodge, Madikwe Safari Lodge is located in the central-eastern region of Madikwe Game Reserve. The area surrounding the lodge is well known for its rich biodiversity and provides some of the best game-viewing opportunities on the reserve.

**GPS co-ordinates:** should not be followed as these may get guests lost and most recommended routes are not navigable by normal vehicle.

### Weather

Average maximum temperatures range from 23°C/73°F in July to 40°C/104°F in January, with the lowest average minimum occurring in July at 2°C/36°F • The region is semi-arid, with an average annual rainfall of 500mm (20in), occurring mostly during the summer months (December - February) • Rain is usually in the form of thundershowers, where a downpour is experienced, very seldom lasting longer than a few hours

### Best Time to Travel

A year-round safari destination • The animals in Madikwe Game Reserve are non-migratory, and variation in the safari experience is season rather than location related • The best period for birdwatching is from October to April

### Health Info: Malaria

Kopano Lodge, Madikwe Safari Lodge is situated in a region of South Africa that is not inhabited by the malaria-carrying mosquito (Anopheles) and is therefore classified MALARIA FREE.

## Kopano Lodge Layout

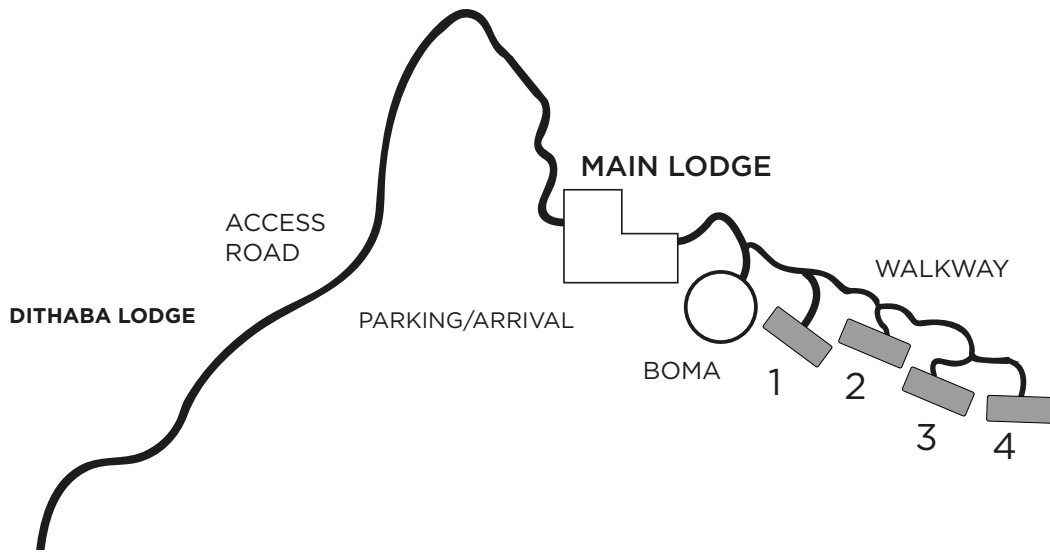

## Kopano Lodge Suite Layout

Interior - 50m<sup>2</sup> | 540ft<sup>2</sup>  
Exterior - 50m<sup>2</sup> | 540ft<sup>2</sup>  
Total - 100m<sup>2</sup> | 1 080ft<sup>2</sup>

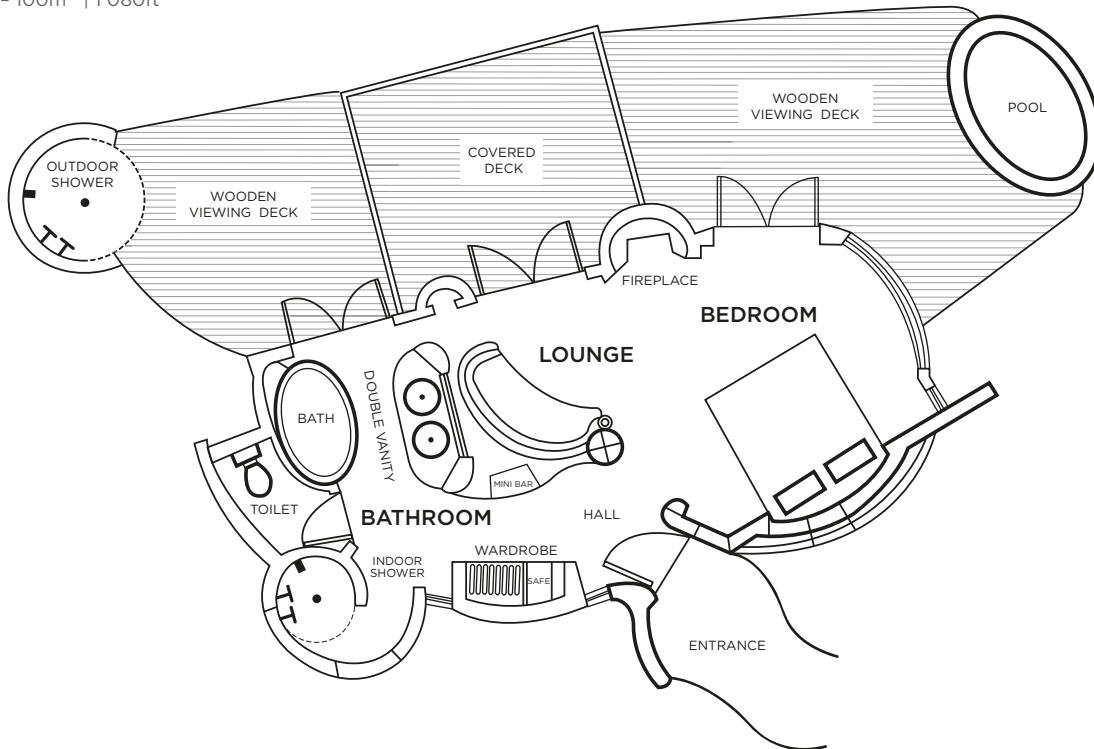

## Reference Table - Kopano Lodge

Reference	Kopano Lodge
Suites	4 Suites
Size of suites	100m <sup>2</sup> /1 080ft <sup>2</sup>
Guests	8
Children	>16 (all ages if booked exclusively)
Children's rate	<5 (free) 6 to 15 (50% of adult rate)
Children on safari	Private game drive (all ages) Twice-daily game drive (>6)
Children activities	No
Childminding	No
Triple rooms (sleeper couch)	0
Single traveller supplement	Yes (50% supplement)
Double bed convertible to twin	Yes
Central guest pool	No
Private plunge pool	Yes
Air conditioning	Yes
Fireplace	Yes
Room fans	Yes
Mosquito nets	Yes
Outdoor shower	Yes
Indoor showers	Yes
Separate WC	Yes
Free Wi-Fi	Yes
Satellite television	No
In-room telephone	Yes (direct dial)
Mobile coverage	Average: 60% (MTN/Vodacom)
In-room safe	Yes
Minibar	Yes
Hairdryer	Yes
Laundry	Yes (additional cost)
Conference facilities	No
Spa facilities	In-room treatments (additional cost)
Gym facilities	Yes - 'Gym in a Basket' (with a yoga mat, weights, resistance bands, and jump rope)
Suitable for disabled guests	Yes (with assistance)
Distance between rooms	10-15m/33-49ft
Airstrip	Yes (15 minutes away) 24°44'0"S   26°24'25"E
Helipad	Yes (24°43'11.8"S   26°23'4.2"E)
Guests per open safari vehicle	6
Private open safari vehicle	Yes (additional cost, subject to availability)
Languages of field rangers	English, Afrikaans
Gratuities recommendation	ZAR600* per guest per day *Specific allocations clarified on request
Kosher dining	Yes (with prior notice, at an additional cost)
Power	220V AC
Credit cards	Mastercard, Visa, Amex
Cheques	Not accepted